

TEAR - A - STRIP CURTAINS by Stripcurtains.com

Installation Instructions

Universal Mounting Hardware: Constructed of 14 gauge galvanized steel with permanent 1/4" studs, snap caps, and pre-drilled holes for mounting or suspension.

- A. **Header Mount:** to overhead surface of lintel inside doorway
- B. **Wall Mount:** to wall surface immediately over doorway
- C. **Threaded Rod:** suspended by clamp and 1/2" rod (not included) from overhead beam

1. From the illustrations (A, B, or C) on the right, determine the type of mounting desired.
2. Attach hardware to surface. Use minimum 5/16" fasteners (supplied by others). For Header Mount, hardware may have to be cut to fit opening.
3. Choose strip overlap (illustration D).
4. Attach strips to permanent 1/4" studs, making sure concave surfaces face each other (illustration E). Place snap caps snugly against each strip. Inserting three (3) caps per foot of hardware is recommended.

Concave/Convex Construction: Allows strips to interlock when hung, forming an excellent seal.

Modifications: If the final strip does not match the standard overlap, we suggest altering the last strip (or strips). PVC strip material can be trimmed to width using a straight edge and a utility knife. Score the material, then tear off the excess.

Replacing Strips

1. Remove snap caps.
2. Remove strips to be replaced.
3. Install new strips, making sure that concave sides face each other.
4. Replace snaps snugly against each strip.

Note: For best results, prior to installation unroll vinyl strips and place flat in warm area for a minimum of 24 hours. (F)

Maintenance: Vinyl strips can be cleaned with a household detergent and water. Rinse thoroughly with water after cleaning. Do not use bleach or ammonia.

Warranty: Manufacturer warrants this product to be free of defects in material and workmanship for a period of 120 days from user's purchase date.

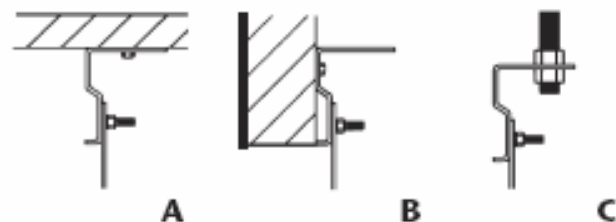
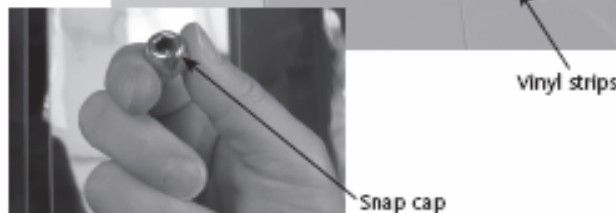

Partial Overlap 8" & 16" Wide Strip



Full Overlap 8", 12" & 16" Wide Strip



Partial Overlap 12" Wide Strip

